

WIS Series

CHARACTERISTICS

- Small size and higher inductance available
- Small tolerance available
- j

APPLICATION

- Filter
- 8

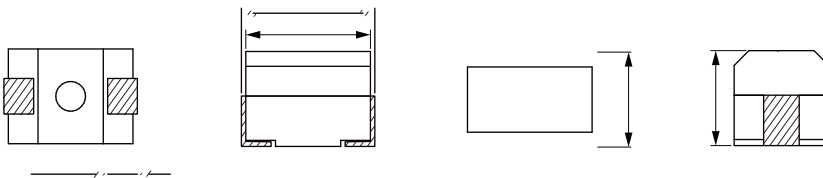

Part No	Inductance	Tolerance	Q Min.	Test Freq	SRF Min.	DCR Max.	Temperature Rise Current Max.
† @ M	18				16		
† @ M	22				14		
† @ M	27				13		
† @ M	33				12		
† @ M	39				11		
† @ M	47						
† @ M							
† @ M	68						
† @ M	82						
† @ M					8		
† @ M					7		
† @ M					6		
† @ M							
† @ M					0		
† @ M						12	92
† @ M						14	
† @ M						18	
† @ M						26	62
† @ M					3		
† @ M					3		
† @ M							
† @ M							

$\frac{1}{u} \left(\frac{1}{C} - \frac{1}{C'} \right) \# \dots \dots \dots u \cdot C$

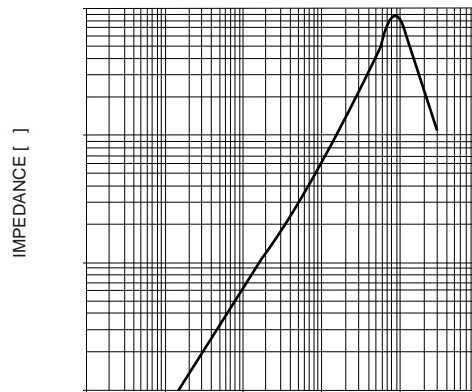
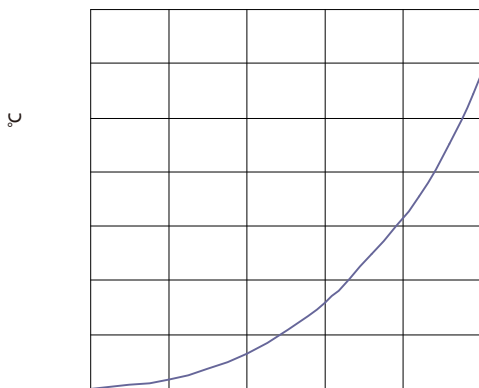

C

C

IMPEDANCE []

IMPEDANCE []

C

IMPEDANCE []